

# Harrisons

ESTATE AGENTS



19 Doris Avenue, Bolton, Lancashire, BL2 6DB



19 Doris Avenue, Bolton,  
Lancashire, BL2 6DB

**Offers in Excess of  
£105,000**

**PROPERTY FEATURES AND DETAILS**

OFFERED WITH NO CHAIN

BAY-FRONTED MID-TERRACE

FAMILY LOUNGE

POSSIBLE RENTAL AT £550 FOR INVESTORS



**PROPERTY INFORMATION**

This property is in council tax band A

Doris Avenue, Tonge Fold, Bolton, Lancashire. **\*\*Offered With No Chain\*\***  
Are you looking for your first home or a buy to let investment? We are pleased to offer to market this spacious 2 bedroom mid-terrace property in Tonge Fold, just off Bury Road! **LEASEHOLD - 893 YEARS REMAINING**  
**TRANSPORT** Bolton Rail Station 1.16 miles Hall i' th' Wood Rail Station 1.3 miles Moses Gate Rail Station 1.68 miles Farnworth Rail Station 2.16 miles  
**EDUCATION** Forwards Centre 0.33 miles Park School Teaching Service 0.33 miles Leverhulme Community Primary School 0.43 miles Moorgate Primary School 0.53 miles Bolton Parish Church CofE Primary School 0.61 miles  
**SUPERMARKETS** Co-Op Late Shop 0.42 miles Co-op Late Shop 0.54 miles Tesco 0.6 miles Aldi 0.75 miles The Cooperative 0.82 miles Morrisons 0.83 miles  
Viewings are now going ahead - Contact Emma in branch today!

### **Entrance Porch 3' 3" x 3' 3" (1m x 1m).**

Laminate wood flooring. UPVC front door. Gas box. Ceiling light..

### **Lounge 13' 9" x 14' 7" (4.2m x 4.45m).**

Laminate wood flooring. Gas fireplace with marble plinth and surround. Pendant calling light. Bay fronted window with openers. Broadband connection. Double panel radiator. Ariel connection. .

### **Kitchen/Diner 13' 10" x 15' 0" (4.22m x 4.58m).**

Wood laminate flooring. 3 pendant ceiling lights. 2 recess ceiling spotlights. Oak wood cupboards with blue laminate worktop. 4 ring gas burner with built in oven and extractor fan. Sink area - White cupboards with wood countertop. Stainless steel sink with drainage board and mixer tap. Patio doors leading to rear yard. .

### **First Floor Landing 5' 9" x 5' 0" (1.74m x 1.52m).**

Carpet flooring, pendant ceiling light, loft hatch.

### **Bedroom 1 14' 0" x 10' 5" (4.27m x 3.17m).**

Carpet flooring. Pendant ceiling light. Double panel radiator. Double glazed unit to rear with large bottom opener. .

### **Bedroom 2 8' 6" x 13' 7" (2.59m x 4.13m).**

Fitted wardrobes. Carpet flooring. Pendant ceiling light. Double glazed unit to rear with opener. Single panel radiator..

### **Bathroom 4' 11" x 9' 3" (1.49m x 2.83m).**

Lino flooring. White 3 piece suite. Shower over bath with mixer tap. Glass shower screen. Tiled walls. Pull cord Light. 5 recess ceiling spotlights. Chrome towel heated radiator. Wall mounted toilet roll holder..





GROUND FLOOR  
811 sq.ft. (75.3 sq.m.) approx.

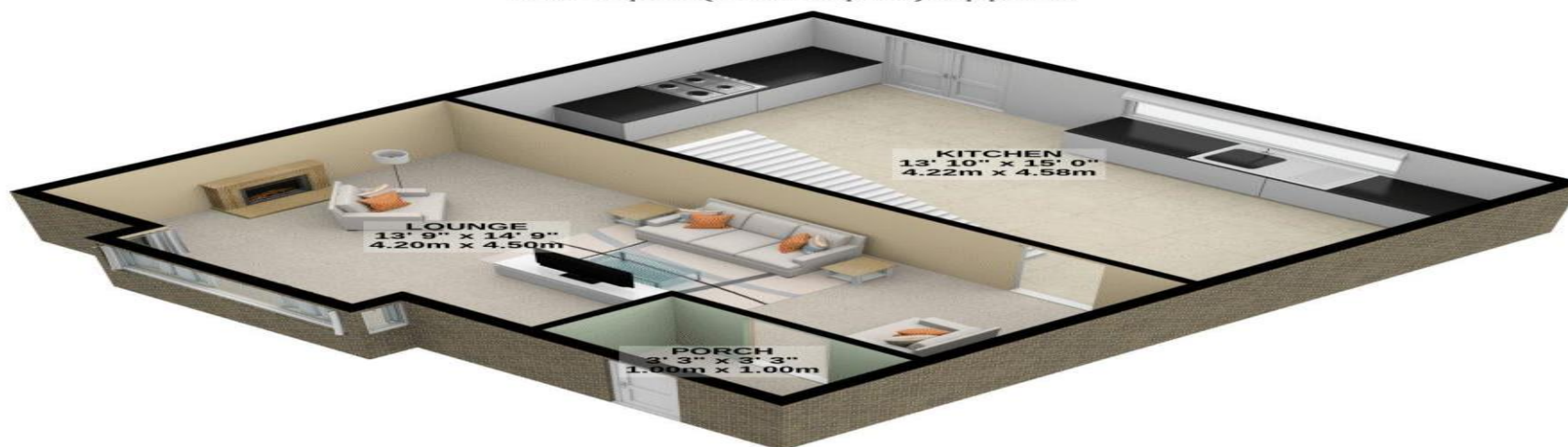

1ST FLOOR  
802 sq.ft. (74.5 sq.m.) approx.

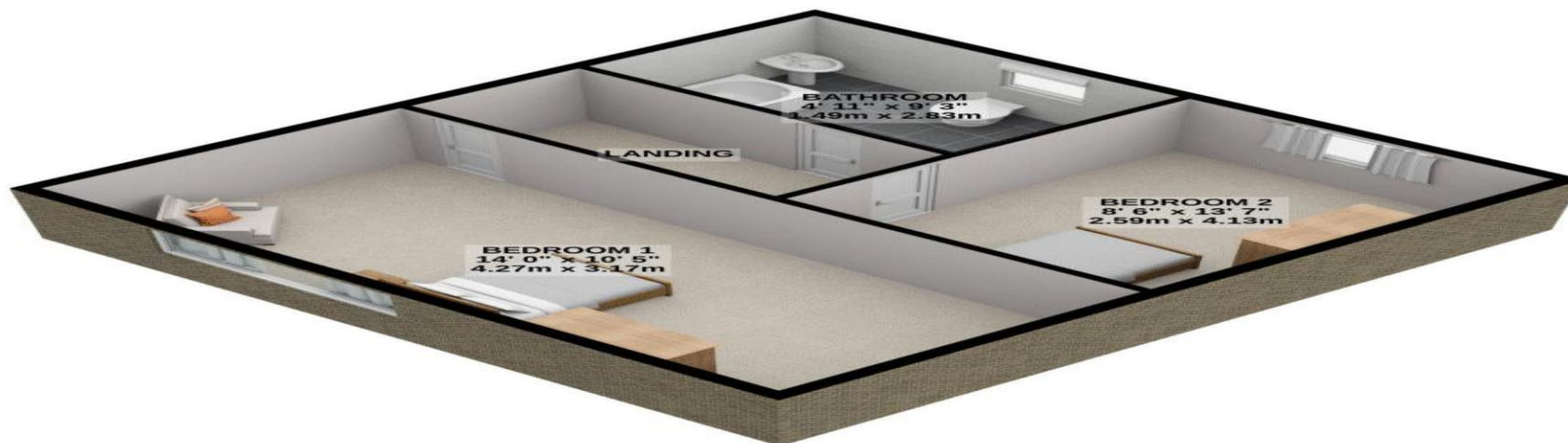

TOTAL FLOOR AREA : 1613 sq.ft. (149.8 sq.m.) approx.

For illustrative purposes only. Decorative finishes, fixtures, fittings and furnishings do not represent the current state of the property. Measurements are approximate. Not to scale.  
Made with Metropix © 2021